

HÚSIN Á HOLTINU

heilsusamlegt borgarumhverfi



YRKI
ARKITEKTAR



HELSTU FORSENDUR

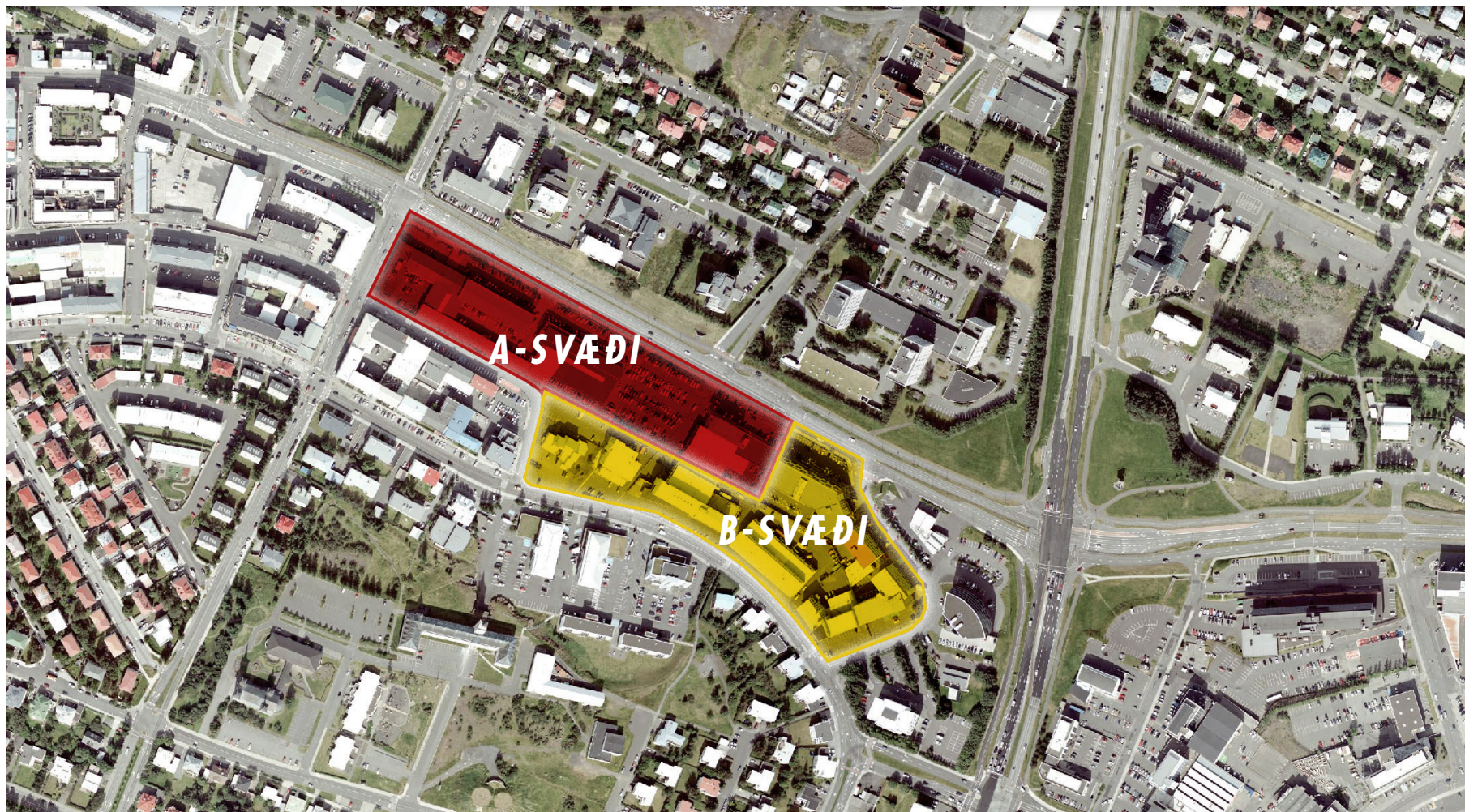

BORGARLÍNA

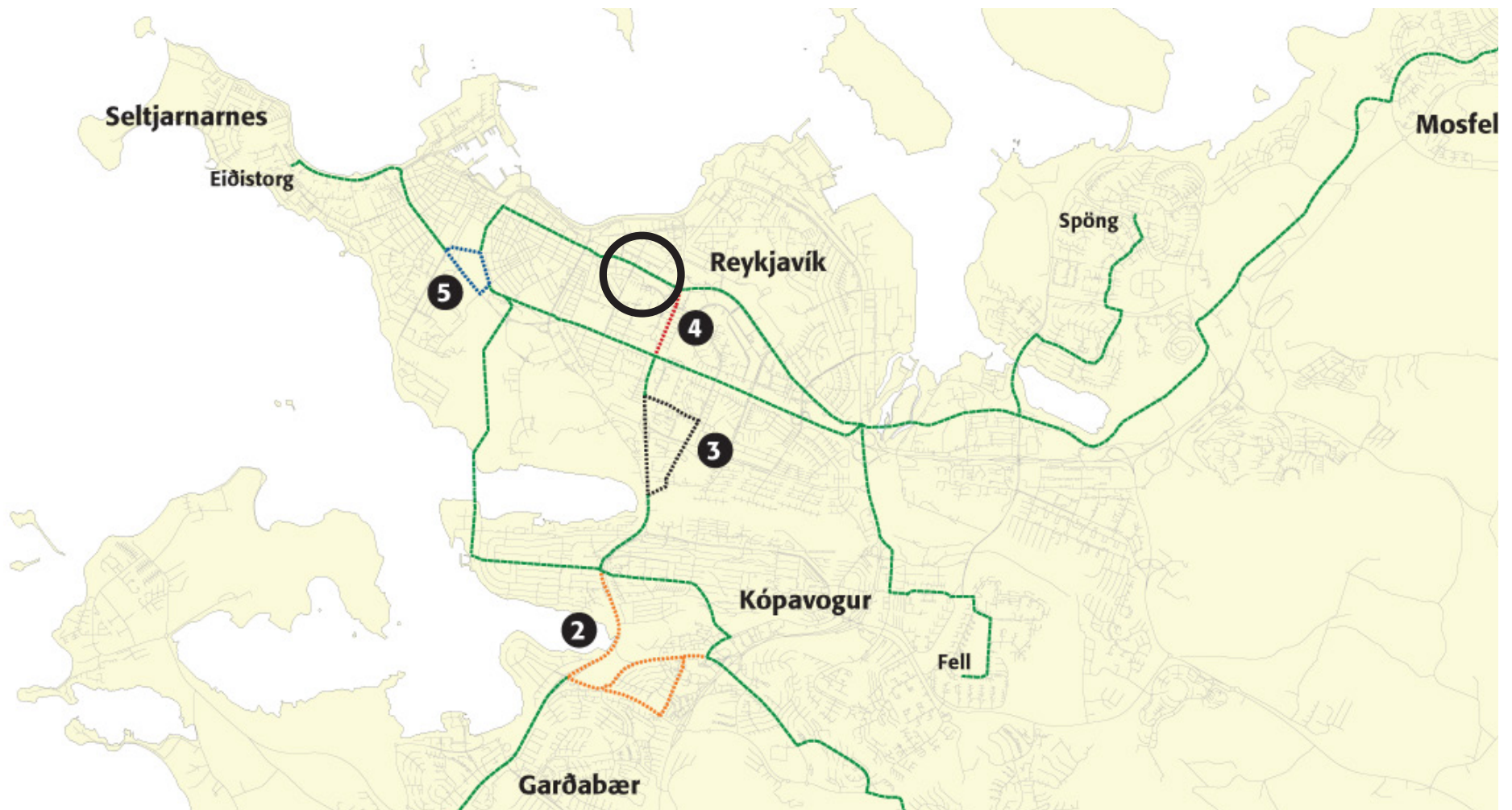

ÞRÓUNARÁS



STAÐAN Í DAG



GREINING Á AÐSTÆÐUM

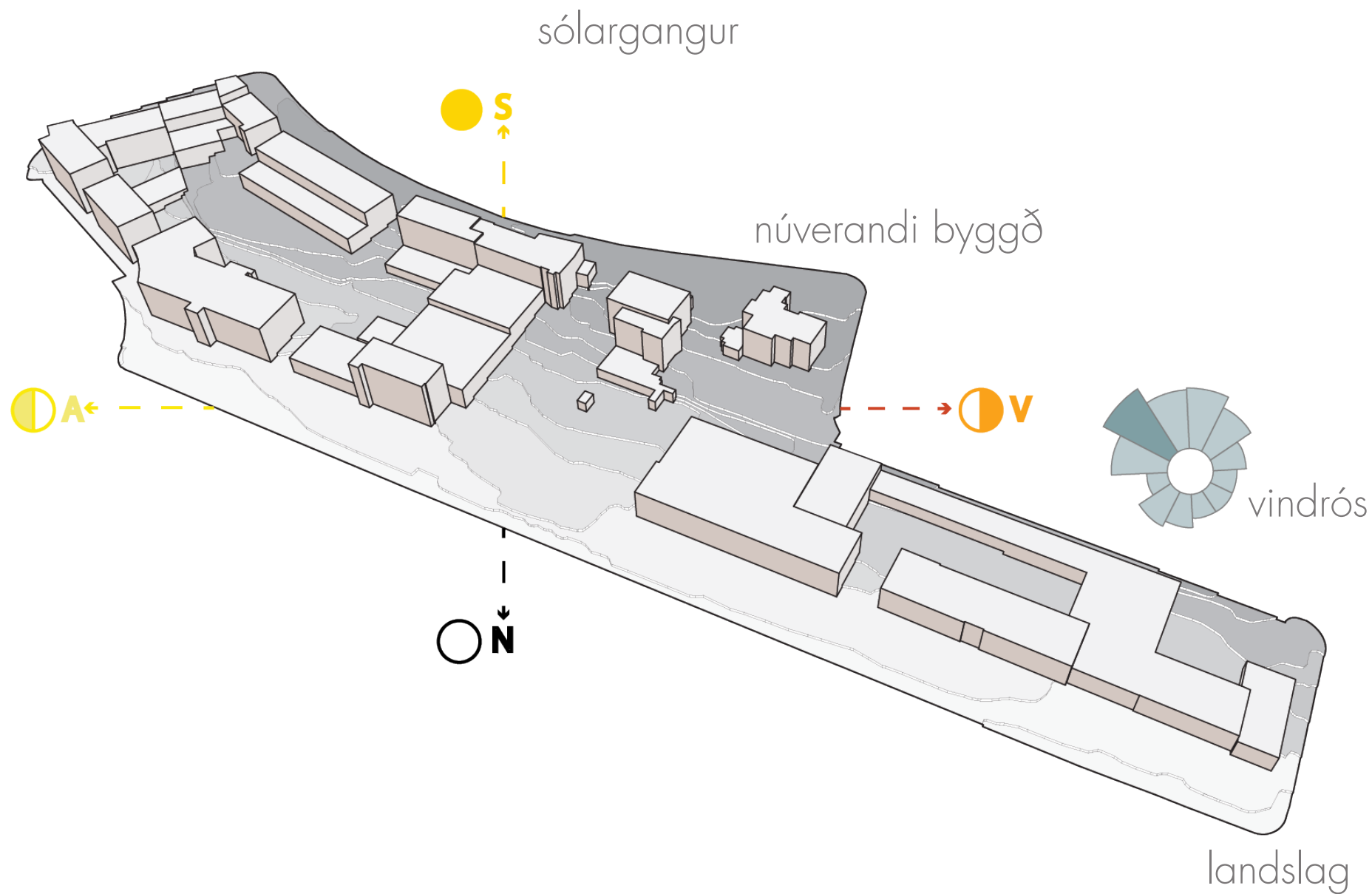

BYGGÐ SEM HALDIÐ ER Í

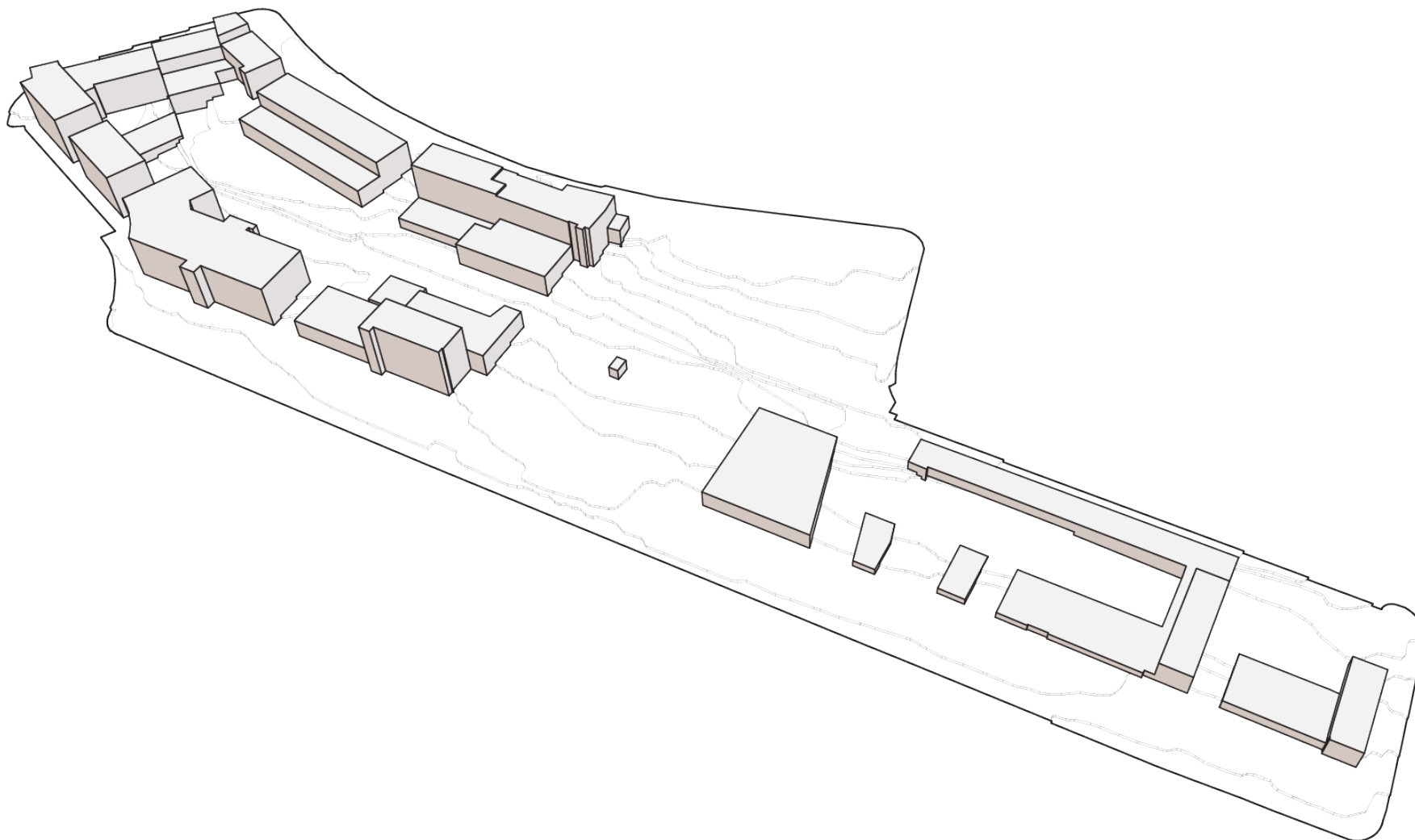

MÓTUN BYGGÐAR

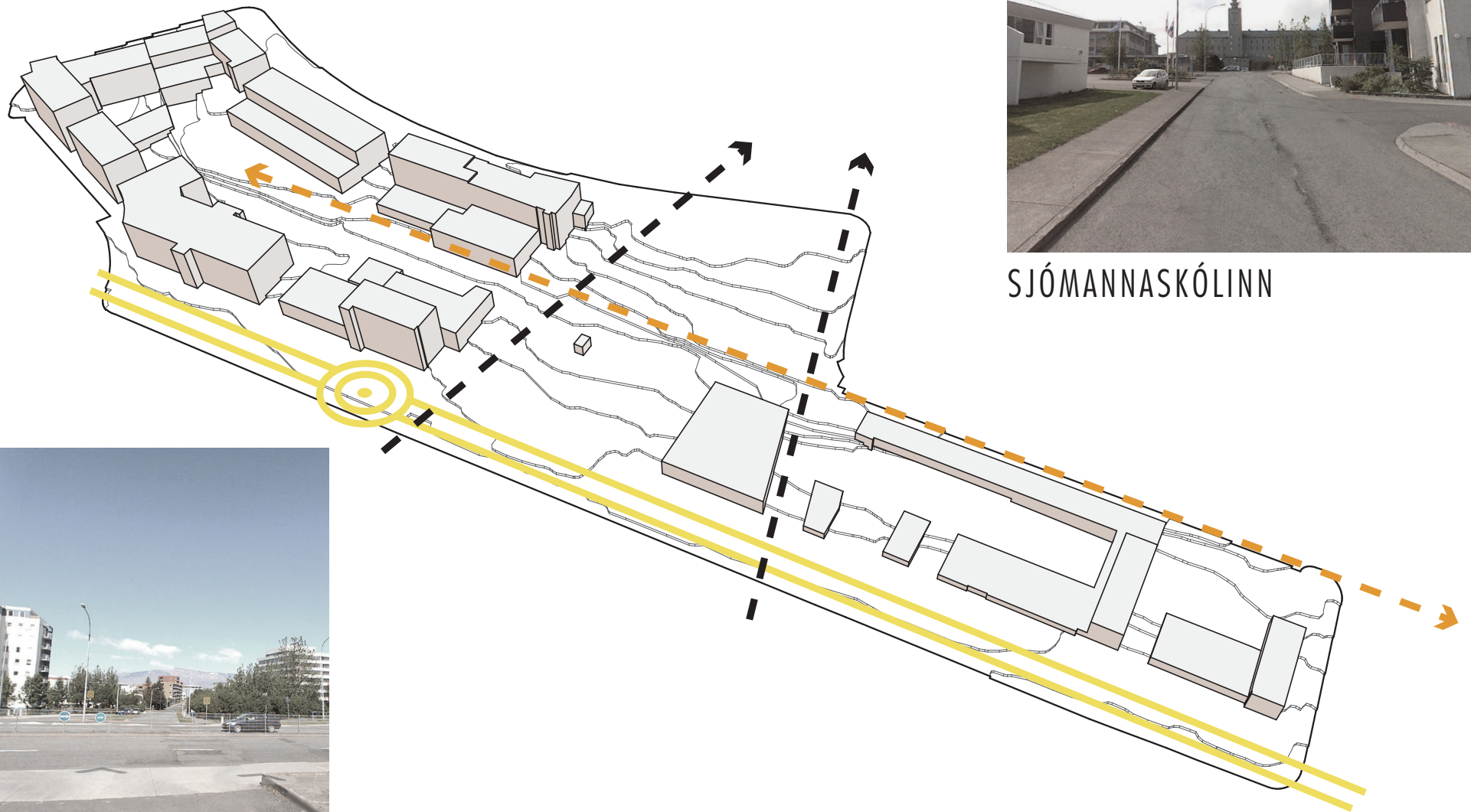

SJÓMANNASKÓLINN



HÁTÚN

MÓTUN BYGGÐAR

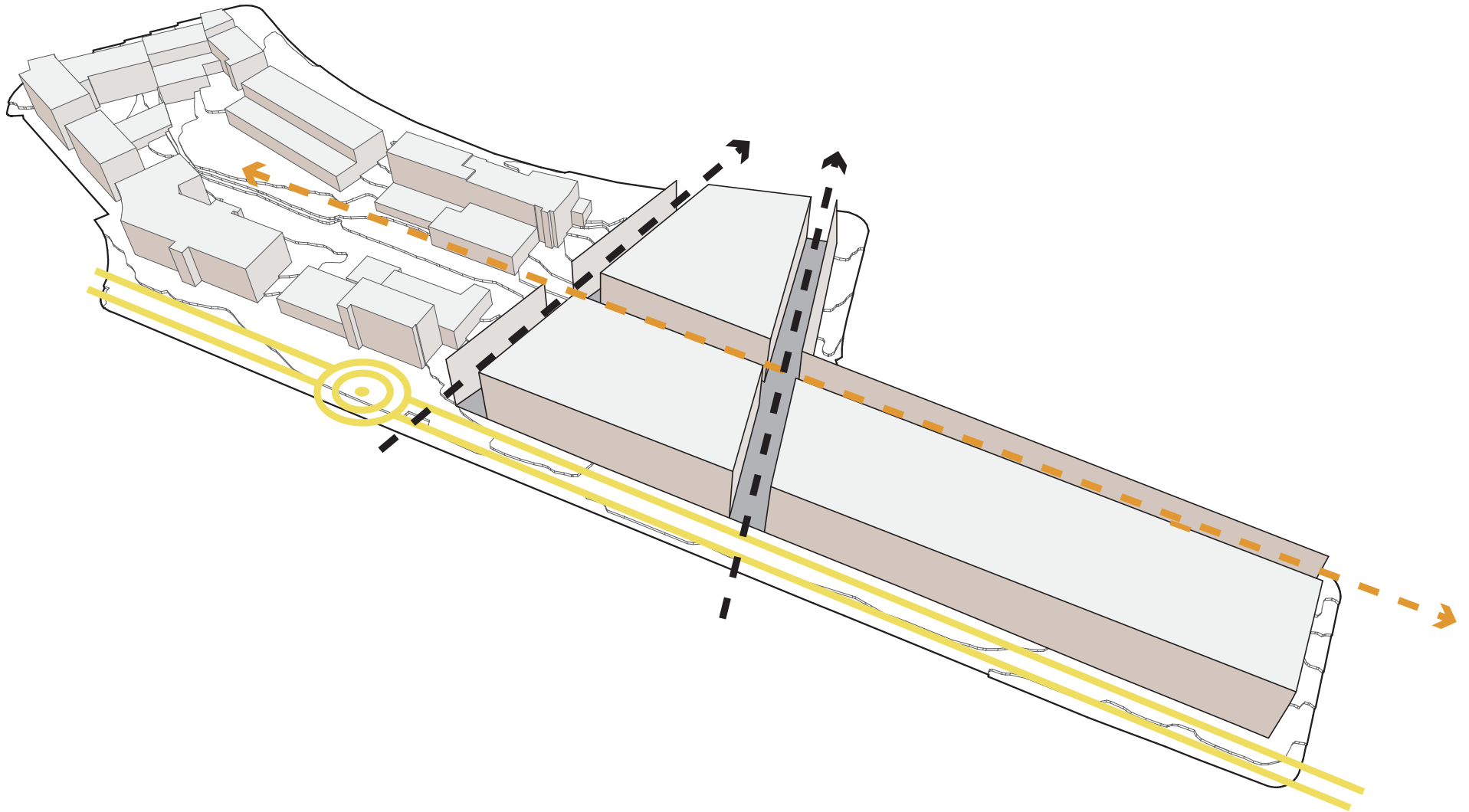

GÖNGUGATAN

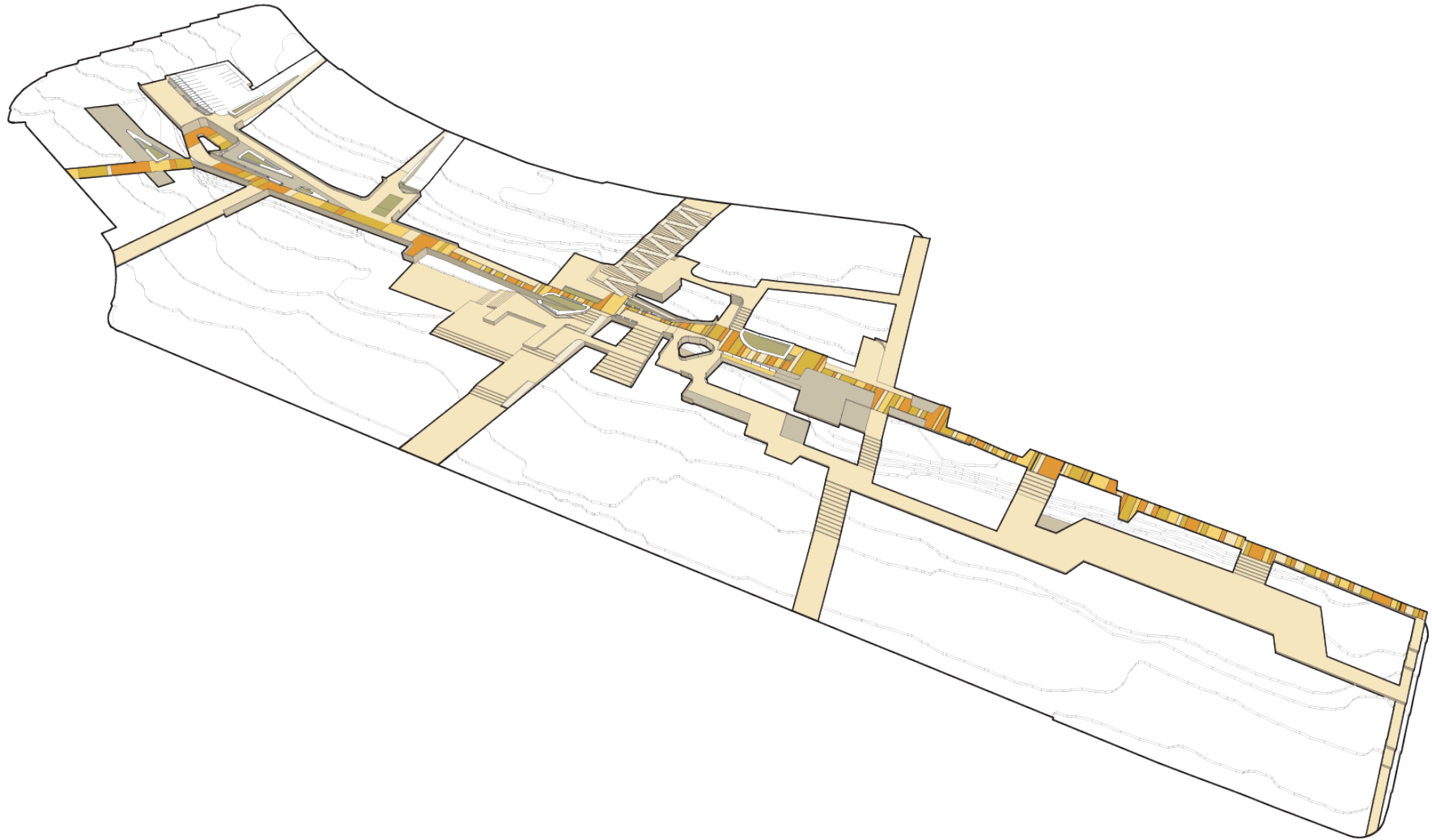

MÓTUN BYGGÐAR

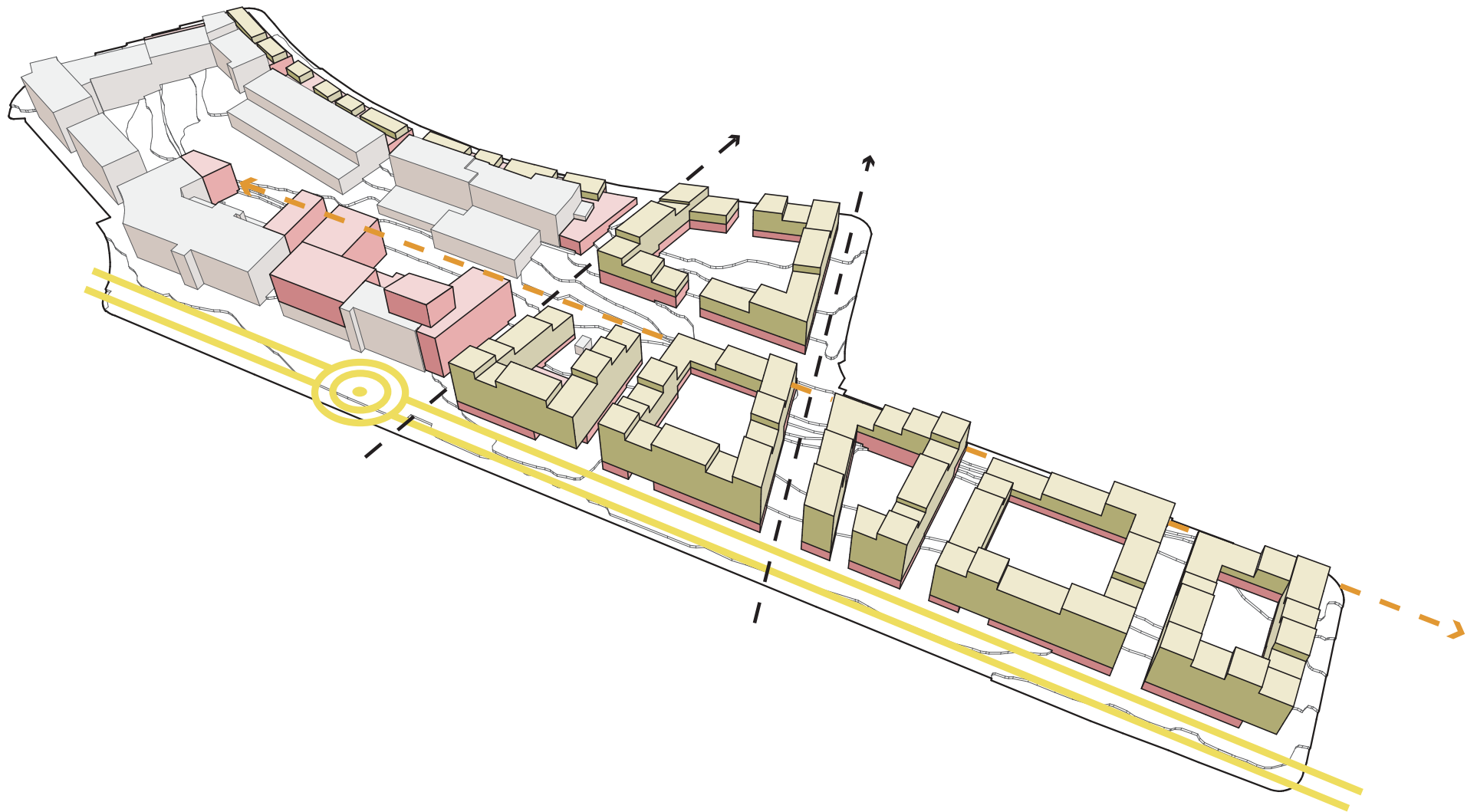

GÖNGUGATAN



KJALLARAR & AÐKOMUR

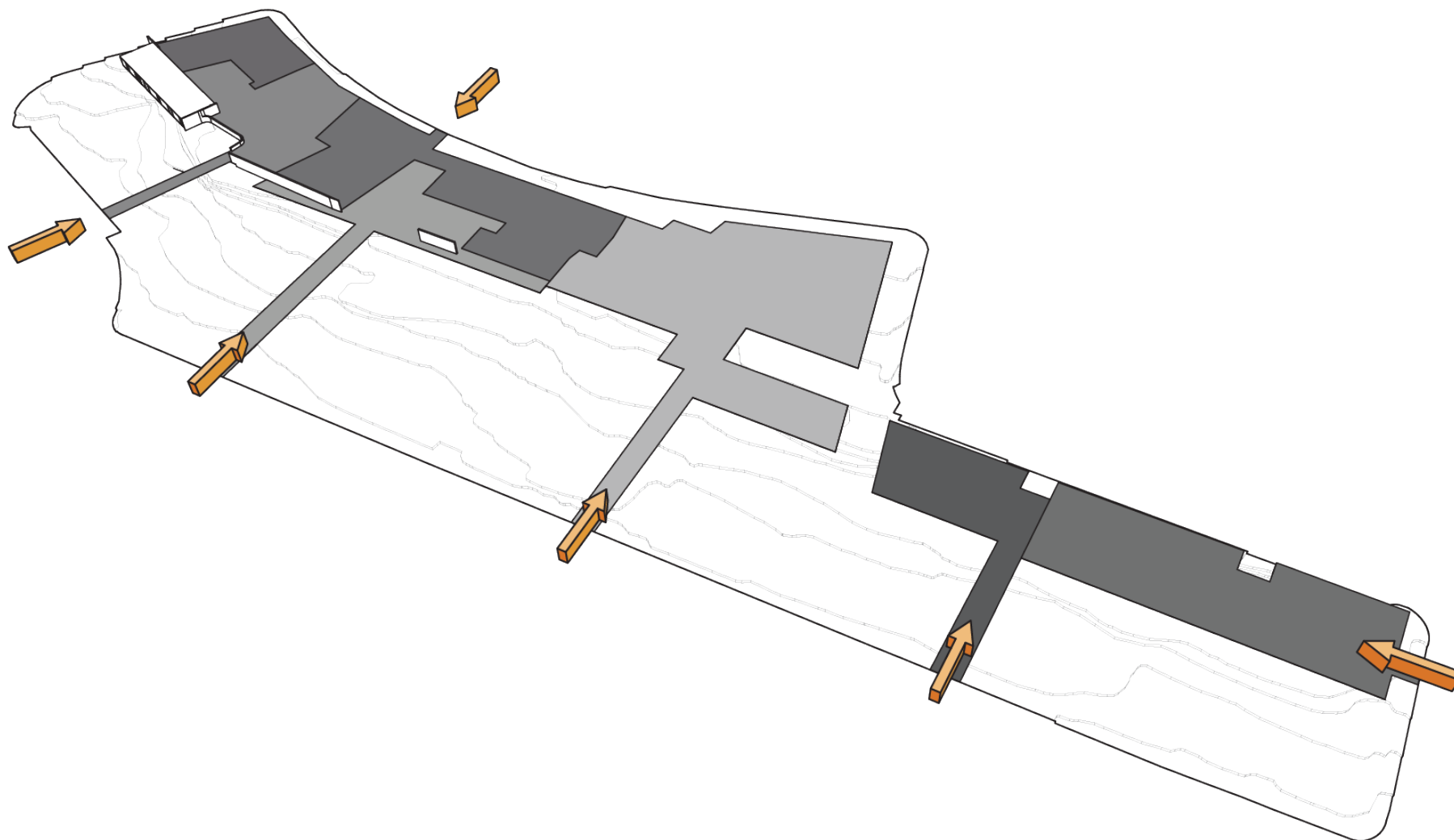

AFSTÖÐUMYND



EININGAR

Uppbygging reitsins er hugsuð í einingum
Grunneiningin er 80 m².

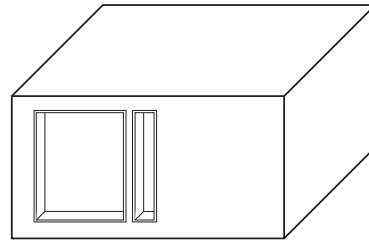

EININGAR

Henni er hægt að skipta upp í tvær 40m² einingar
eða stækka upp í 120m², 160m², 240m² o.s.frv..
Einingarnar eru sveigjanlegar í notkun og henta
grunnformin bæði til íbúðar og fyrir atvinnustarfsemi.

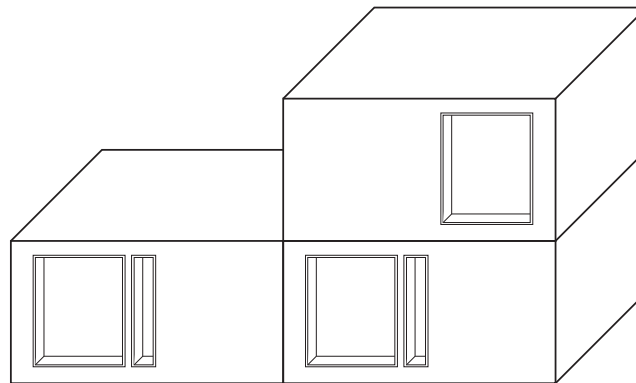

EININGAR

Hægt er að stýra uppbyggingunni eftir því hver eftirspurnin er hverju sinni. Uppbyggingin einkennist af sveigjanleika og ríkulegu svigrúmi til breytinga.

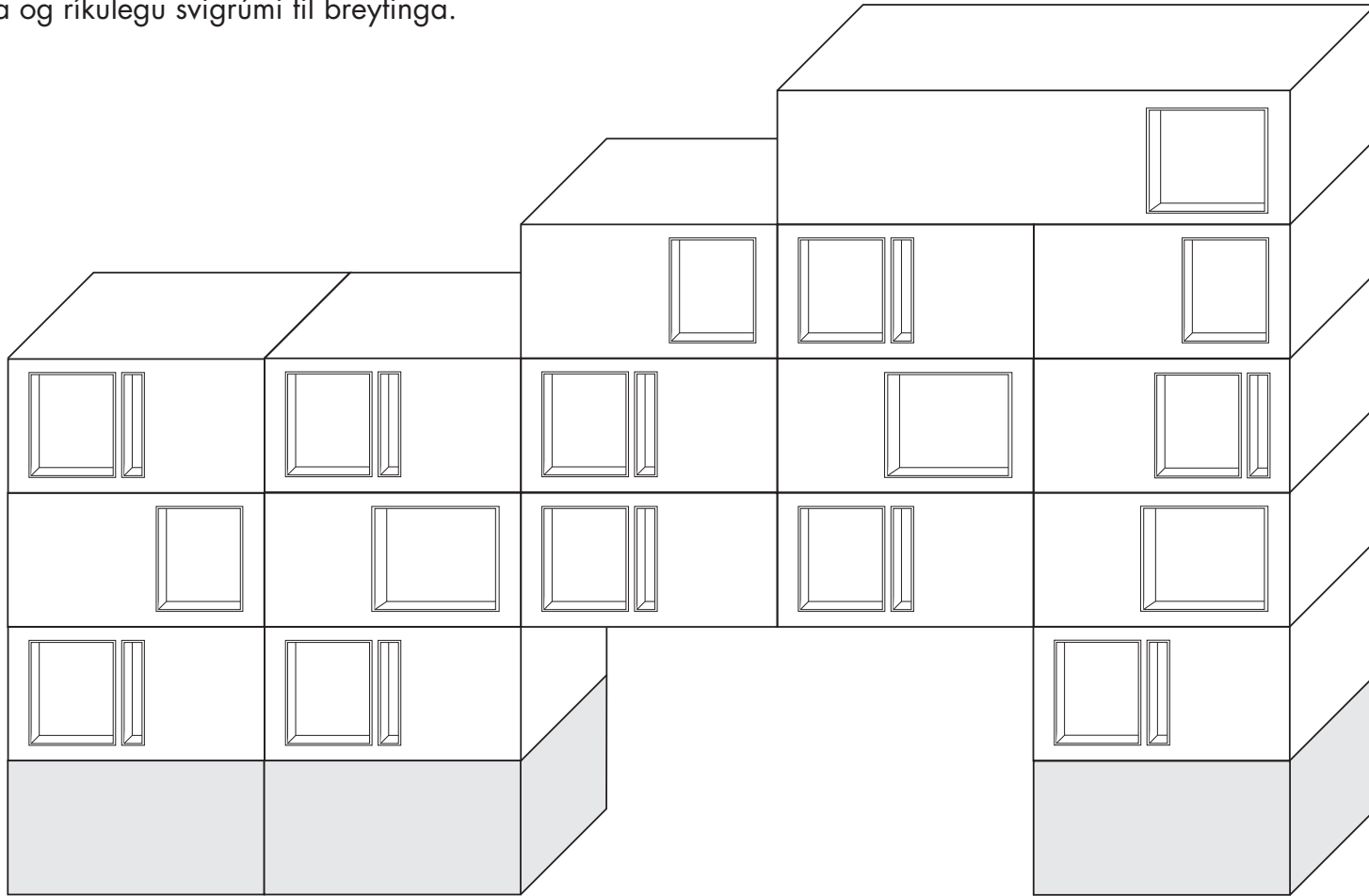

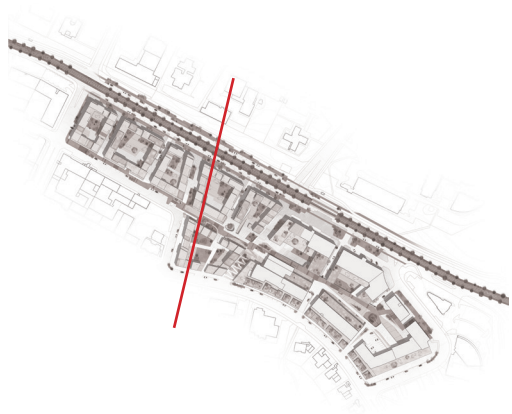
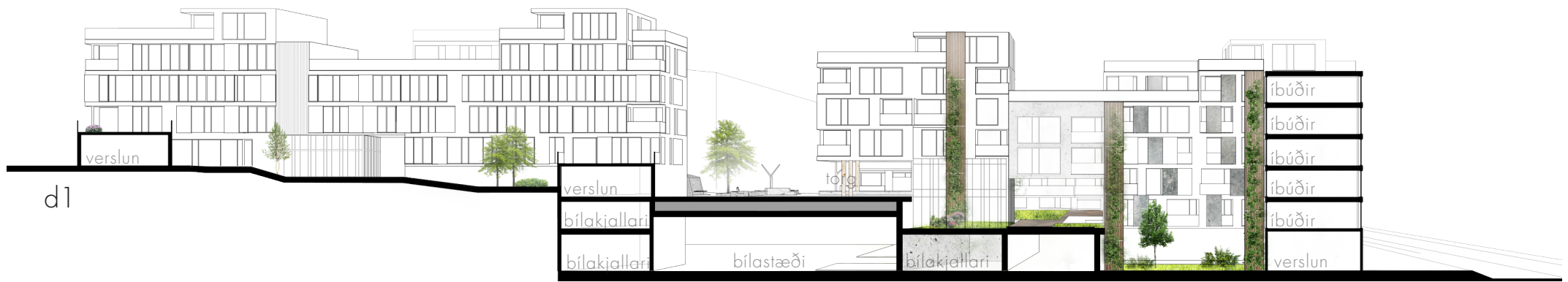

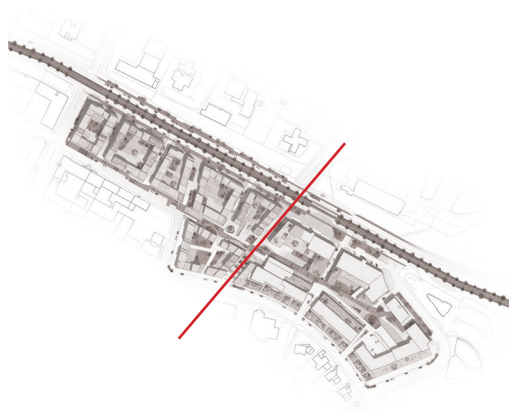
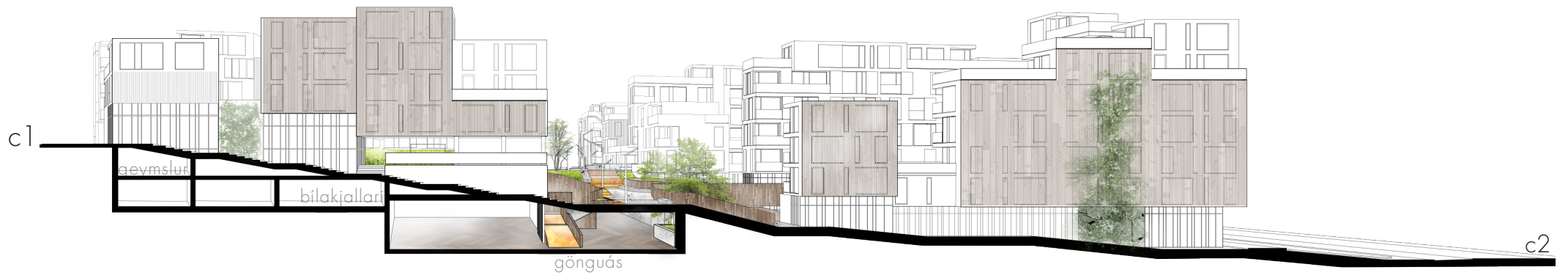

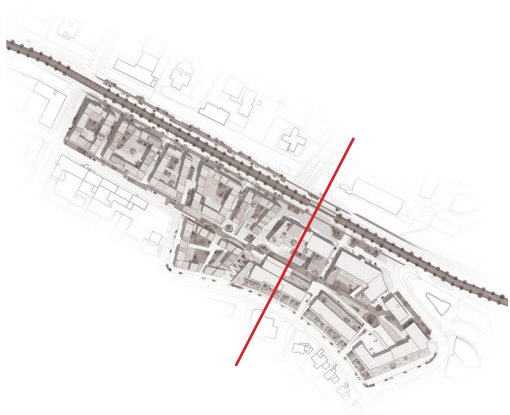

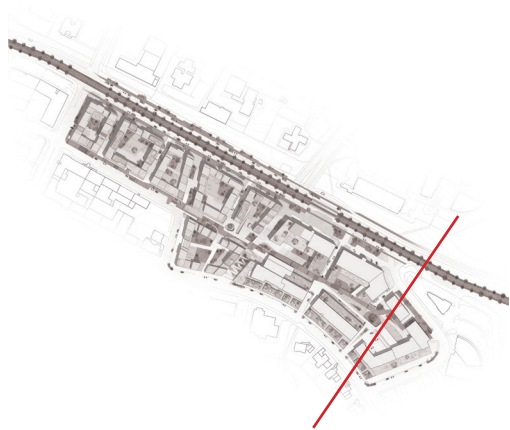





YRKI
ARKITEKTAR

